

## Single Output Industrial Power Supplies

### Features

- ◆ Power factor Corrected
- ◆ Wide range output adjustment
- ◆ Single wire current share
- ◆ Input transient protection
- ◆ UL508 Industrial Controls Approval
- ◆ Factory Mutual Approval (Class 1, Div 2)
- ◆ 5 Year Warranty
- ◆ EN61000-4 Input Transient

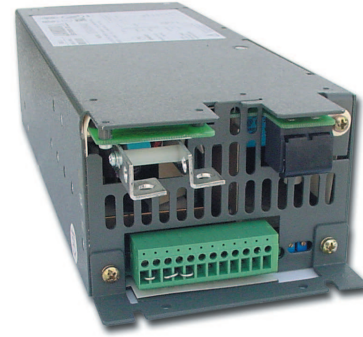

Specifications		JFS0500	JFS0750	JFS1000	JFS1500	JFS2000
AC Input Voltage	-	85-265VAC (170-265VAC JFS2000), 47-63Hz				
DC Input Voltage Range	-	120-330VDC (240-330VDC for JFS2000)				
Input Current (typ@110VAC)	A rms	6	9	12	20	12 <sup>(1)</sup>
Inrush Current (110 / 220VAC)	A	35 / 70				- / 70
Efficiency (typ@110VAC)	%	75				82 <sup>(2)</sup>
Power Factor	-	Meets EN61000-3-2 (0.99 typical)				
Overcurrent Protection	-	<110% (auto recovery)				
Overvoltage Protection	V	24V models set at 30V, 48V models set at 60V (auto recovery)				
Hold Up Time (Typ)	ms	16				
Transient Reponse	-	For 25% load change, recovers to regulation within 5ms				
Remote Sense	-	Compensates for 0.25V drop per leg				
Remote Adjust	-	With either external Resistor or Voltage				
Remote On / Off	-	Low = OFF, Open = ON				
Signals & Indicators	-	Open Collector AC Fail and DC Good, Green LED				
Parallel Connection	-	Single wire current share				
Operating Temperature	°C	-20 to +70°C, derate linearly to 50% load from 50°C (30 min warm up at -20°C)				
Storage Temperature	°C	-40 to +85				
Humidity (non condensing)	%RH	10 - 90				
Cooling	-	Internal fan				
Withstand Voltage	-	Input - Ground 2kVAC, Input - Output 3kVAC, Output - Ground 500VDC				
Vibration	-	Per IEC68-2-6				
Shock	-	Per IEC68-2-27				
Safety Agency Approvals	-	UL508, UL60950, CSA22.2 No.60950, EN60950, FM3611 & CE Mark				
Conducted & Radiated EMI	-	EN55022 Class A, FCC Docket 20780 Part 15, subpartJ, Class A				
Weight (Net / Shipping)	lbs	6 / 7	7 / 8		9 / 10	
Size (WxHxD)	mm	See output line drawings				
Warranty	-	5 years				

Notes: (Consult Installation Manual for detailed specifications, test methods and application notes)

(1) At 220VAC

(2) At 170VAC

# OBSOLETE

## Output Ratings

Model	Nom. Volt.	Adjust. Range	Min Load	Max Current	Load Reg (mV)	Line Reg (mV)	Ripple & Noise (mV p-p)
JFS0500-24	24V	20 - 29	0	20.8	< 240	< 240	250
JFS0750-24	24V	20 - 29	0	31.2	< 240	< 240	250
JFS1000-24	24V	20 - 29	0	41.6	< 240	< 240	250
JFS1500-24	24V	20 - 29	0	62.5	< 240	< 240	250
JFS2000-24	24V	20 - 29	0	83.3	< 240	< 240	250
JFS0500-48	48V	36 - 56	0	10.4	< 480	< 480	500
JFS0750-48	48V	36 - 56	0	15.6	< 480	< 480	500
JFS1000-48	48V	36 - 56	0	20.8	< 480	< 480	500
JFS1500-48	48V	36 - 56	0	31.2	< 480	< 480	500
JFS2000-48	48V	36 - 56	0	41.6	< 480	< 480	500

## JFS0750/1000 Outline Drawing

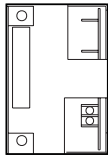

FRONT VIEW

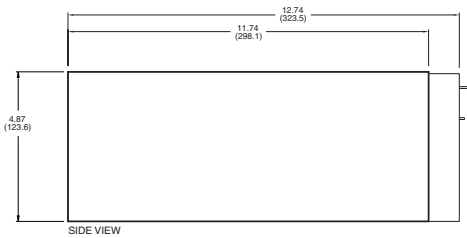

SIDE VIEW

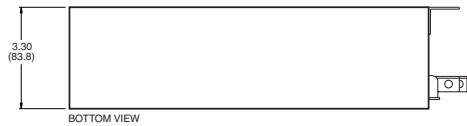

BOTTOM VIEW

NOTE:  
1. DIMENSIONS ARE IN INCHES EXCEPT DIMENSIONS ( ) ARE IN MM.  
2. WEIGHT: NET 7.0 LBS, SHIPPING 8.0 LBS.

## Other Industrial Products

HWS	15W to 1500W Single Output
LZS, LZSa	250W to 1500W Single Output
DLP, DPP, DSP	10 to 480W DIN Rail Single Output

For Additional Information, please visit  
[us.tdk-lambda.com/lp/products/jfs-series.htm](http://us.tdk-lambda.com/lp/products/jfs-series.htm)



## JFS0500 Outline Drawing

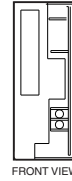

FRONT VIEW

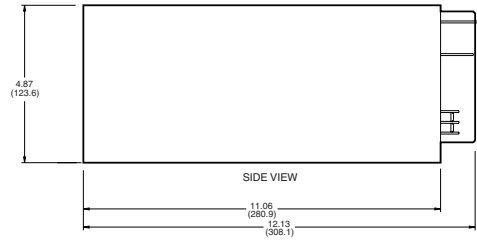

SIDE VIEW

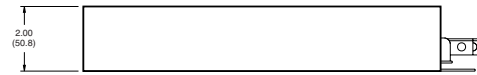

NOTE:  
1. DIMENSIONS ARE IN INCHES EXCEPT DIMENSIONS ( ) ARE IN MM.  
2. WEIGHT: NET 6.0 LBS, SHIPPING 7.0 LBS.

PRELIMINARY

## JFS1500/2000 Outline Drawing

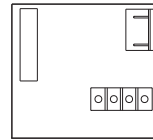

FRONT VIEW

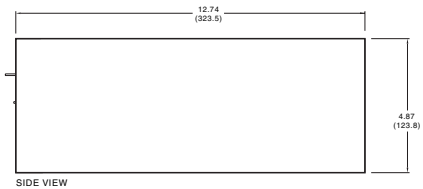

SIDE VIEW

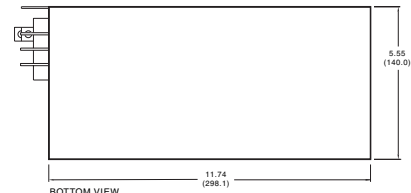

BOTTOM VIEW

NOTE:  
1. DIMENSIONS ARE IN INCHES EXCEPT DIMENSIONS ( ) ARE IN MM.  
2. WEIGHT: NET 9.0 LBS, SHIPPING 10.0 LBS.

# OBSOLETE